

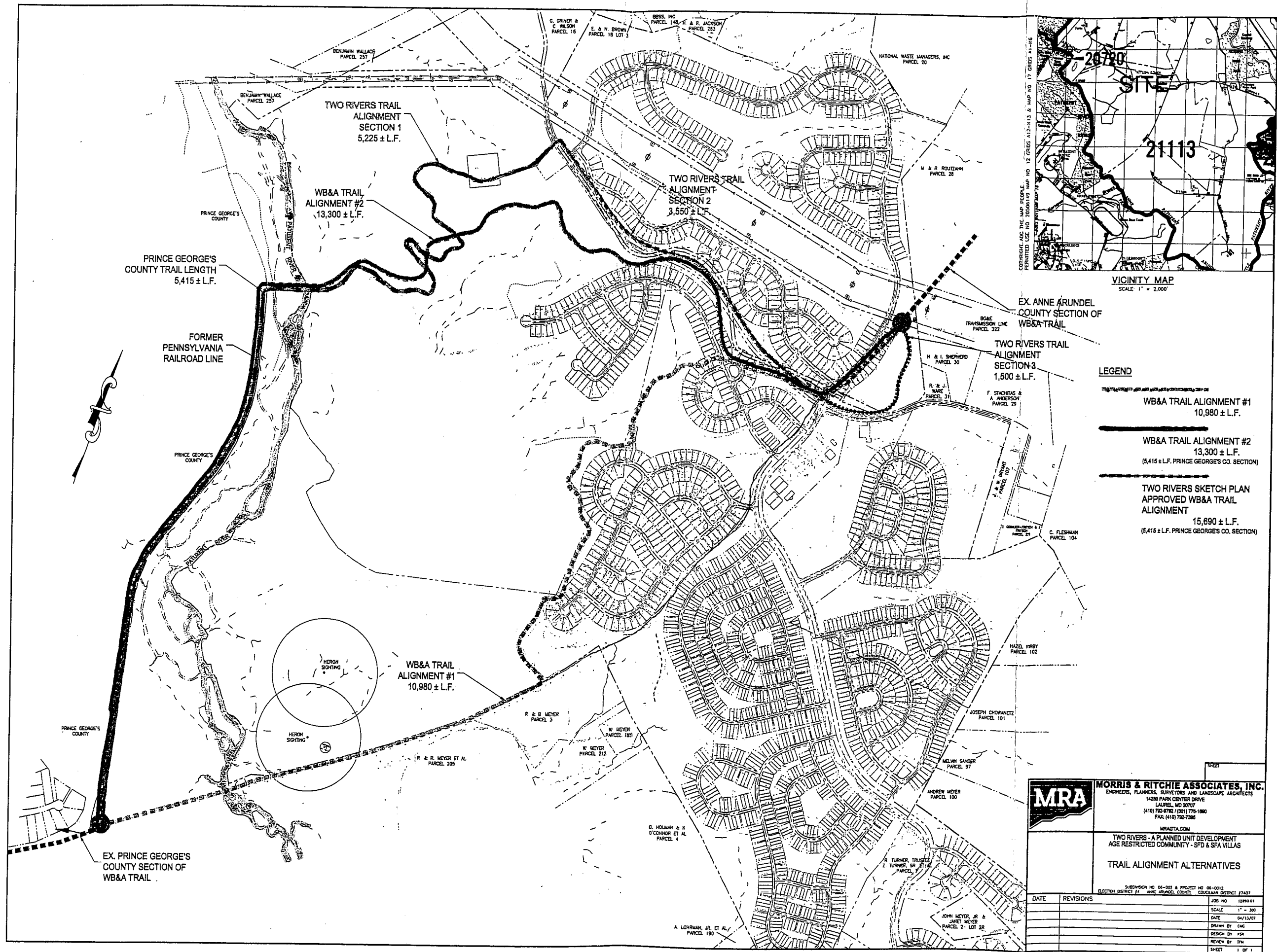



P:\PROJ\12890-02\LDE\SK\Plot\Exhibits\TRAIL-ALTS-070412.dwg, 4/24/2007 8:30:35 AM, cgaliber, 1:3, Copyright 2007 Morris & Ritchie Associates, Inc.



**LEGEND**

-  WB&A TRAIL ALIGNMENT #1  
10,980 ± L.F.
-  WB&A TRAIL ALIGNMENT #2  
13,300 ± L.F.  
(5,415 ± L.F. PRINCE GEORGE'S CO. SECTION)
-  TWO RIVERS SKETCH PLAN  
APPROVED WB&A TRAIL  
ALIGNMENT  
15,690 ± L.F.  
(5,415 ± L.F. PRINCE GEORGE'S CO. SECTION)



**MORRIS & RITCHE ASSOCIATES, INC.**  
ENGINEERS, PLANNERS, SURVEYORS AND LANDSCAPE ARCHITECTS  
14280 PARK CENTER DRIVE  
LAUREL, MD 20707  
(410) 752-8782 / (301) 775-1880  
FAX: (410) 752-7388  
MRA@GTA.COM

TWO RIVERS - A PLANNED UNIT DEVELOPMENT  
AGE RESTRICTED COMMUNITY - SPD & SFA VILLAS  
**TRAIL ALIGNMENT ALTERNATIVES**

SUBDIVISION NO. 06-003 & PROJECT NO. 06-003-012  
ELECTION DISTRICT 11 ANNE ARUNDEL COUNTY, MARYLAND DISTRICT 17407

DATE	REVISIONS	JOB NO.
		12890-01
		SCALE 1" = 300'
		DATE 04/13/07
		DRAWN BY CAC
		DESIGN BY MSR
		REVIEW BY JTM
		SHEET 1 OF 1